

LOFTS ON THE GREEN

Conveniently located in the heart of our new active adult community, Lofts On The Green offers seven amazing floor plans. Each choice includes spacious balconies, perfect for sipping morning coffee as the sun rises, and your favorite beverage when the sun sets.

You'll never have to stray far from home with every amenity — pub, dining, theater, spa, fitness, salon, and more — just steps away.

Lofts On The Green is the best of both worlds with a city-living feel in a gorgeous Lake Country setting.

All floorplans are approximate and subject to change. The following prices are valid July 1, 2025, through June 30, 2026.



- 1 Bedroom
- 1 1/2 Baths
- Walk-in Closet
- Laundry Room
- Patio/Balcony
- 1,024 sf

SOHO

	90% Refundable Residency Fee	Monthly Fee
HIGH	\$494,000	\$1,734
LOW	\$347,000	\$2,628





- 1 Bedroom w/Den
- 1 ½ Baths
- Walk-in Closet
- Laundry Room
- Patio/Balcony
- 1,193 sf

DUBLIN

	90% Refundable Residency Fee	Monthly Fee
HIGH	\$567,000	\$1,829
LOW	\$398,000	\$2,855



- 2 Bedrooms
- 2 Baths
- Walk-in Closet
- Laundry Room
- Patio/Balcony
- 1,271 sf

SYDNEY

	90% Refundable Residency Fee	Monthly Fee
HIGH	\$598,000	\$1,840
LOW	\$418,000	\$2,922



- 2 Bedrooms
- 2 Baths
- Corner Residence
- Walk-in Closet
- Laundry Room
- Patio/Balcony
- 1,312 sf

COPENHAGEN

	90% Refundable Residency Fee	Monthly Fee
HIGH	\$616,000	\$1,903
LOW	\$431,000	\$3,018



- 2 Bedrooms
- 2 Baths
- Corner Residence
- Walk-in Closets
- Laundry Room
- Patio/Balcony
- 1,318 sf

VANCOUVER

	90% Refundable Residency Fee	Monthly Fee
HIGH	\$622,000	\$1,930
LOW	\$436,000	\$3,055



- 2 Bedrooms
- 2 Baths
- Corner Residence
- Walk-in Closet
- Laundry Room
- Patio/Balcony
- 1,324 sf

MANHATTAN

	90% Refundable Residency Fee	Monthly Fee
HIGH	\$622,000	\$1,930
LOW	\$436,000	\$3,055



- 2 Bedrooms w/Den
- 2 Baths
- Corner Residence
- Walk-in Closets
- Laundry Room
- Patio/Balcony
- 1,478 sf

LUXEMBOURG

	90% Refundable Residency Fee	Monthly Fee
HIGH	\$701,000	\$2,041
LOW	\$491,000	\$3,311



You're ready to let go of some home-owner responsibilities and everything they came with. You're just not so keen on apartment living — just yet. The perfect transition? Three Pillars' new Courtyard Homes. With two options — 1,313-square-foot 2-bedroom or 1,058-square-foot one bedroom with den - you'll have plenty of space to make it yours.

You'll also be close enough to our amenities so you can get to the spa, theater, and dinner within minutes. All you have to do is open your door, walk through your beautifully-landscaped courtyard, and you're halfway there.

All floorplans are approximate and subject to change. The following prices are valid July 1, 2025, through June 30, 2026.



- 1 Bedroom w/Den
- 1½ Baths
- Walk-in Closet
- Laundry Room
- Front Porch
- 1½ Car Garage
- 1,058 sf

CHELSEA

	90% Refundable Residency Fee	Monthly Fee
HIGH	\$506,000	\$1,723
LOW	\$355,000	\$2,639



- 2 Bedrooms
- 2 Baths
- Walk-in Closet
- Laundry Room
- Front Porch
- Back Patio
- 1½ Car Garage
- 1,313 sf

MANCHESTER

	90% Refundable Residency Fee	Monthly Fee
HIGH	\$585,000	\$1,749
LOW	\$409,000	\$2,809

You used to love the mowing and didn't mind the snow removal if it meant you had your own space and your own home. Now, it's time to leave the shovels, rakes, ladders, and the mower behind and concentrate on "you time." But, you still want your space — your own porch, a nice outdoor area, and plenty of spots for gardening. Insert Three Pillars' Garden Homes, which make leaving your home seem like something you should've done years ago. Come home to a Three Pillars Garden Home and bring your free time. We'll take care of the rest.

All floorplans are approximate and subject to change. The following prices are valid July 1, 2025, through June 30, 2026.

The Fields
AT THREE PILLARS



- 1 Bedroom
- 1 1/2 Baths
- Walk-in Closet
- Laundry Room
- Front Porch
- Patio
- 1 1/2 Car Garage
- 1,264 sf (with optional sunroom)

VERSAILLES

	90% Refundable Residency Fee	Monthly Fee
HIGH	\$628,000	\$1,972
LOW	\$440,000	\$3,109

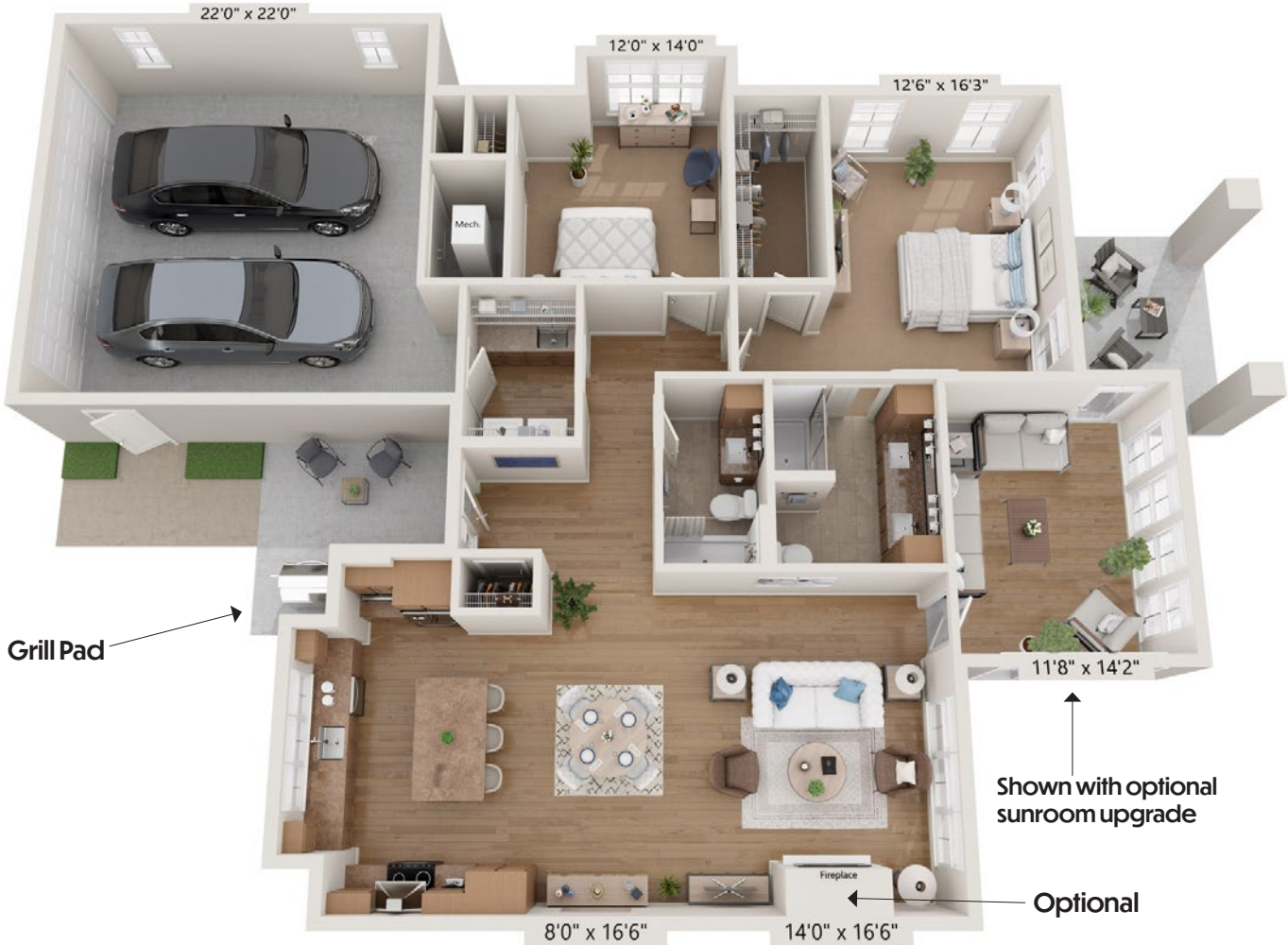

- 2 Bedrooms
- 2 Baths
- Walk-in Closet
- Laundry Room
- Front Porch
- Patio
- 2-Car Garage
- 1,549 sf (with optional sunroom)

SAVANNAH

	90% Refundable Residency Fee	Monthly Fee
HIGH	\$780,000	\$2,142
LOW	\$546,000	\$3,555

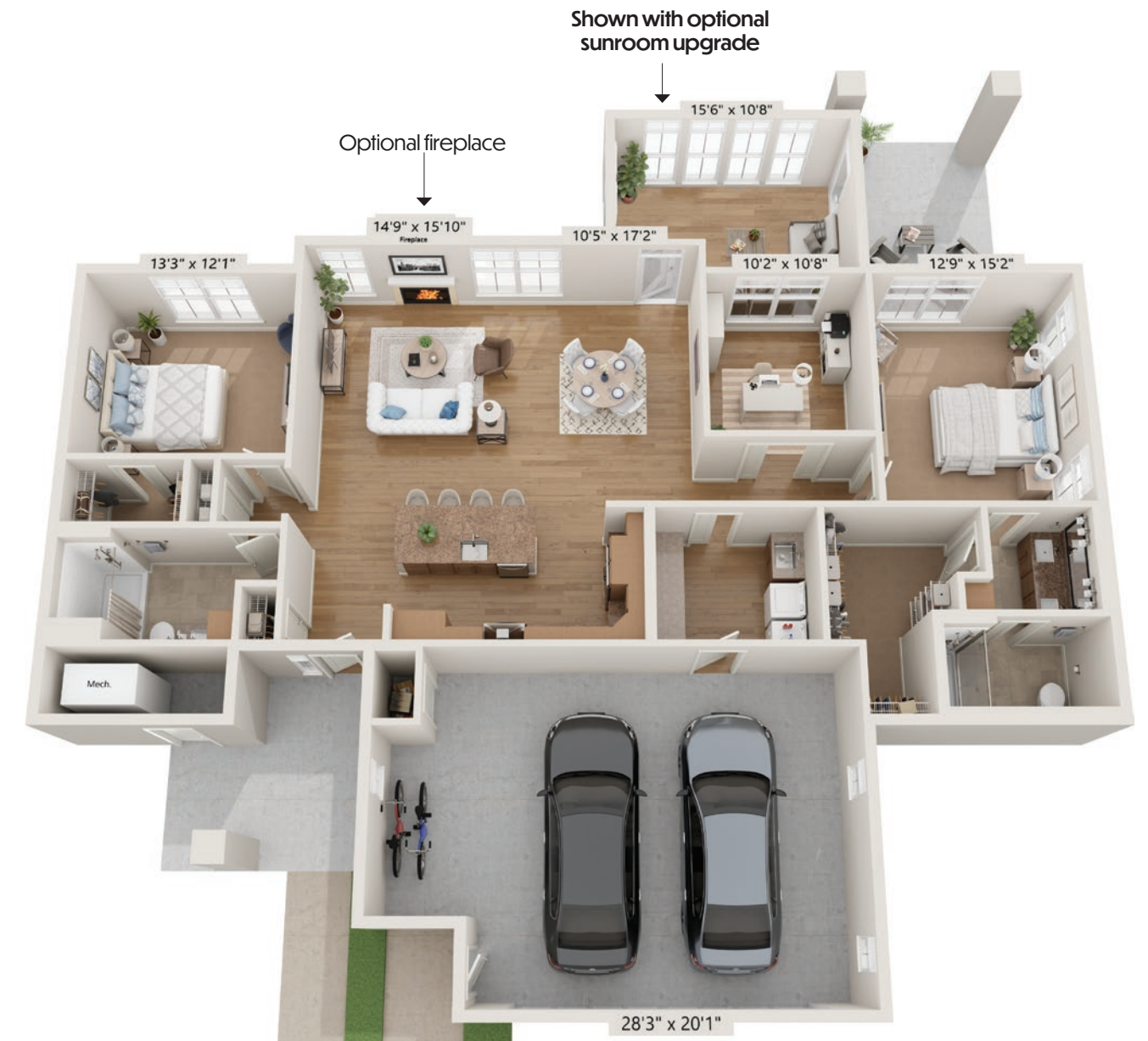

- 2 Bedrooms w/Den
- 2 Baths
- 2.5-Car Garage
- Walk-in Closet
- Laundry Room
- Patio
- 1,821 sf (with optional sunroom)

PASADENA

	90% Refundable Residency Fee	Monthly Fee
HIGH	\$902,000	\$2,608
LOW	\$631,000	\$4,148

- 2 Bedrooms w/Den
- 2 Baths
- 2.5-Car Garage
- Walk-in Closet
- Laundry Room
- Patio
- 1,869 sf (with optional sunroom)

HOLLAND

	90% Refundable Residency Fee	Monthly Fee
HIGH	\$938,000	\$2,728
LOW	\$655,000	\$4,546